

**\*\*LUXURY  
DEVELOPMENT\*\***



Flat - Purpose Built

# APARTMENT 209, 61 SHADWELL STREET, BIRMINGHAM, B4 6LL

## £1,100 PCM

### FEATURES

- LUXURY DEVELOPMENT BY BERKELY GROUP
- ZERO DEPOSIT OPTION AVAILABLE - ENQUIRE FOR DETAIL
- FLOOR TO CEILING WINDOWS WITH JULIETTE BALCONY
- SECOND FLOOR & SOUTH FACING
- CONCIERGE, GYM, SAUNA, STEAM ROOM, CINEMA & MORE!
- 2 MINUTE WALK TO COLMORE ROW / SNOW HILL STATION
- WALK IN WARBROBE & ADDITIONAL STORAGE
- NEWLY BUILT APARTMENT



# 1 Bedroom Flat - Purpose Built located in Birmingham

Call us on

**0121 667 0343**

[hello@swift-property.co.uk](mailto:hello@swift-property.co.uk)

[www.swift-property.co.uk](http://www.swift-property.co.uk)

**\*\*ZERO DEPOSIT SCHEME AVAILABLE – ENQUIRE FOR DETAILS\*\***

Situated in the heart of a vibrant and highly sought-after location, this beautifully presented one-bedroom apartment offers the perfect blend of contemporary style, comfort, and convenience. Spanning approximately 441 sq. ft., the property has been thoughtfully designed to maximise space and functionality, featuring high-quality finishes and a modern aesthetic throughout.

Positioned on the second floor, the apartment benefits from large windows that flood the interior with natural light, creating a bright and airy living environment.

Residents of the development will enjoy a concierge service, full access to the gym, and the convenience of a secure parking space at your disposal.

Ideally located just a short walk from the property is a variety of restaurants, bars, and cafes.

Offering stylish interiors and an outstanding opportunity to own a modern apartment in a prime location.

**Council Tax Band C**

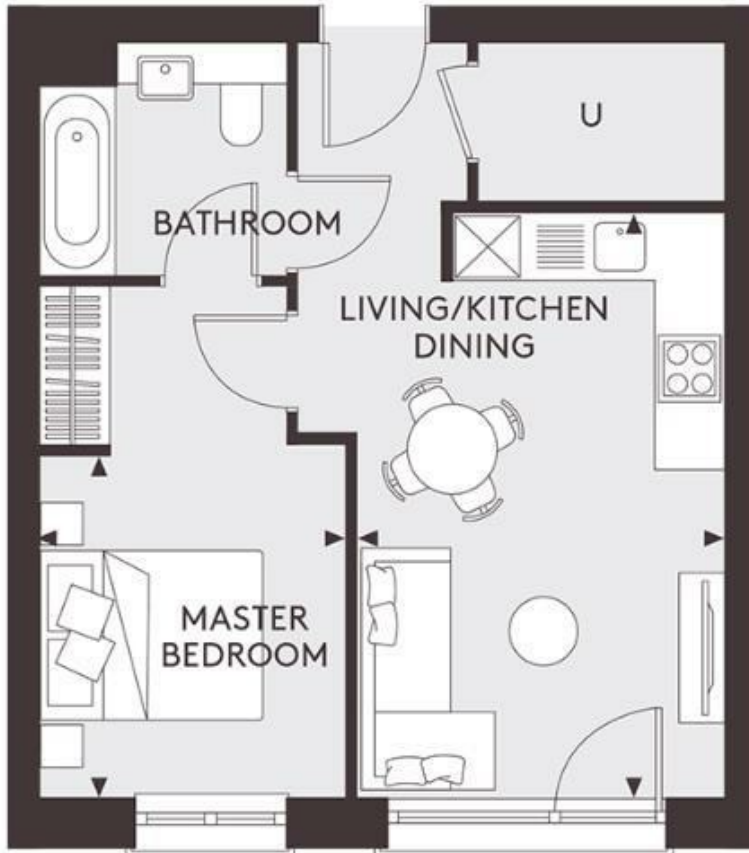

es, including a  
fort and

now Hill Station,  
ks, shops,

artment presents

Agents Note: Whilst every care has been taken to prepare these particulars, they are for guidance purposes only. All measurements are approximate and are for general guidance purposes only and whilst every care has been taken to ensure their accuracy, they should not be relied upon and potential buyers are advised to recheck the measurements.

